

# Armeñime

Reference 108037

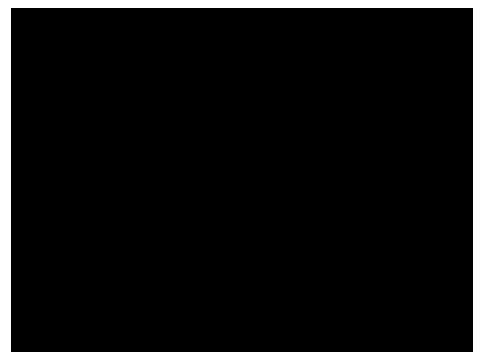

constructed area:	507 m <sup>2</sup>	energy certificate:	in process
plot area:	1.250 m <sup>2</sup>		
bedrooms:	4		
bathrooms:	6		
sea view:	✓	price:	€ 3,400,000.-

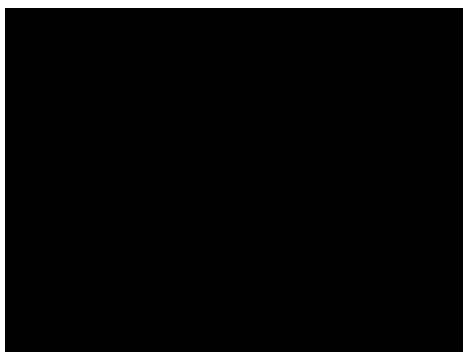
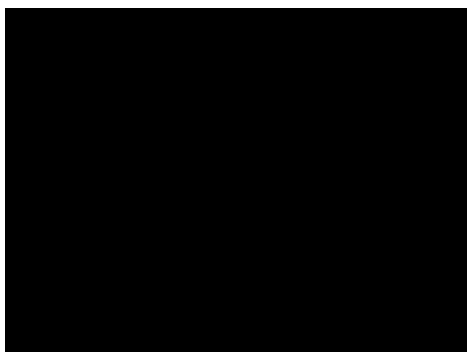

Armeñime  
Reference 108037

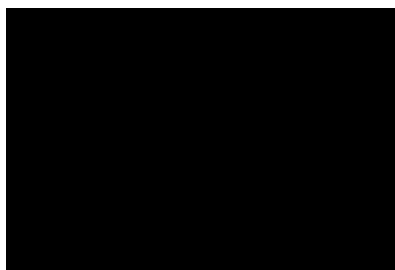

## Details:

All information is correct to the best of our knowledge. Errors and prior sale excepted. This prospectus is purely for information purposes. Only the notarized deed of sale is legally binding.

PORTA TENERIFE • C./ CONQUISTADOR 8, 07001 PALMA  
TEL. +34 971 698 242 • [INFO@PORTATENERIFE.COM](mailto:INFO@PORTATENERIFE.COM)

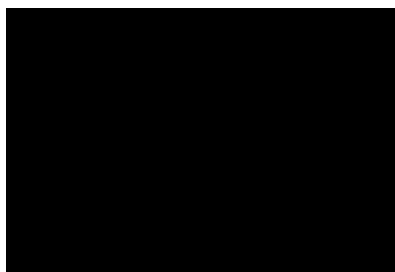

## Location & surrounding area:

Adeje includes numerous popular settlements on the southwest coast of Tenerife, which are known in their entirety and together with the local coastline as Costa Adeje. Under the protection of the volcano Teide, which opposes the trade winds mostly coming from the northeast, the climate is very sunny and the sunsets are even more impressive with the neighbouring island of La Gomera in the background.

On this coast, there are many beaches with the best opportunities for swimming or water sports, from Playa del Duque, Playa de Fañabe, Playa de Torviscas, Playa del Bobo, Playa de las Cuevitas and Playa de Troya up to Playa de las Américas. The marina of Puerto Colón is also a starting point for trips to whale watching, the cliffs of Los Gigantes (max. height 638 meters) and Masca Gorge. Not far from the beaches nestled harmoniously into the landscape, is the 27-hole golf course Golf Costa Adeje, on which to the viewer admires - directly adjacent to the green of the course - the deep blue sea with La Gomera in the background.

The Costa Adeje has excellent infrastructure, various shops, restaurants and a lot of special attractions like the Aqualand and Siam Park. This will benefit owners of the many apartments, houses and villas in the region, but also the community Adeje, which presents itself in bright colours with its beautiful old church, town hall, elegant Canarian wooden balconies and around his cozy Plaza. Other cultural attractions invite you to a contemplative walk through Adeje, such as the cultural center or the large statues of Beethoven and the Guanche-King "El Gran Tinerfe".

Armeñime  
Reference 108037



PORTA TENERIFE®  
Your home. Our passion.

Full view

Villa Infinity Renders 01-25-22

Villa Infinity Renders 01-25-30

Villa Infinity Renders 01-25-24

Villa Infinity Renders 01-25-31

Villa Infinity Renders 01-25-25

All information is correct to the best of our knowledge. Errors and prior sale excepted. This prospectus is purely for information purposes. Only the notarized deed of sale is legally binding.

Armeñime  
Reference 108037



PORTA TENERIFE®  
Your home. Our passion.



Villa Infinity Renders 01-25-23

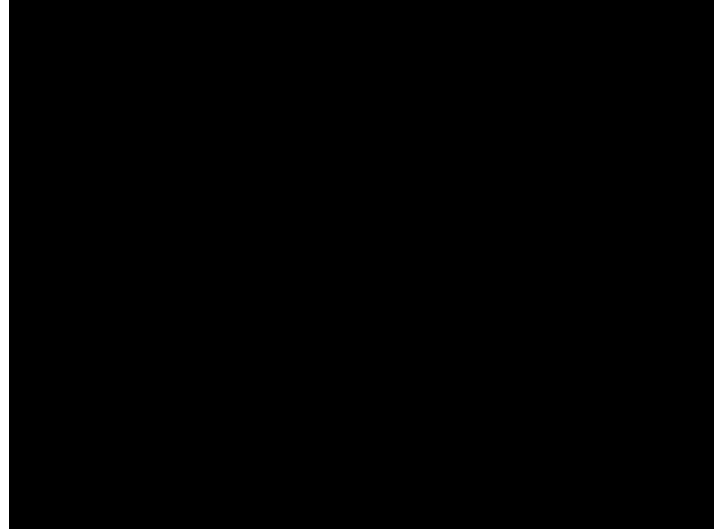

Villa Infinity Renders 01-25-19

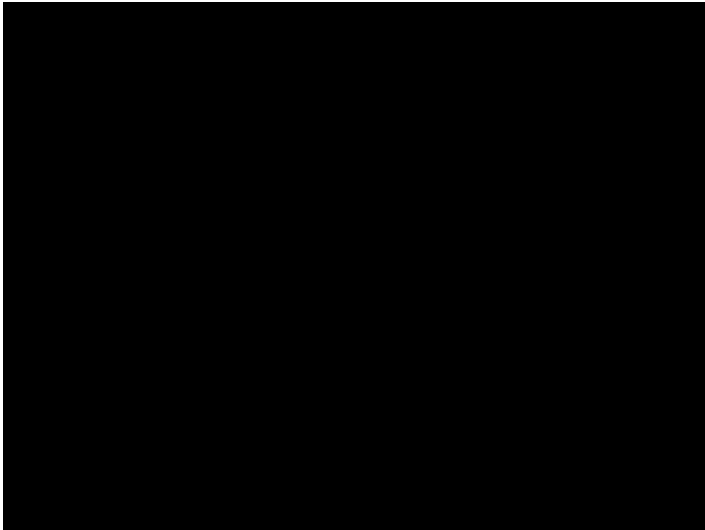

Villa Infinity Renders 01-25-18

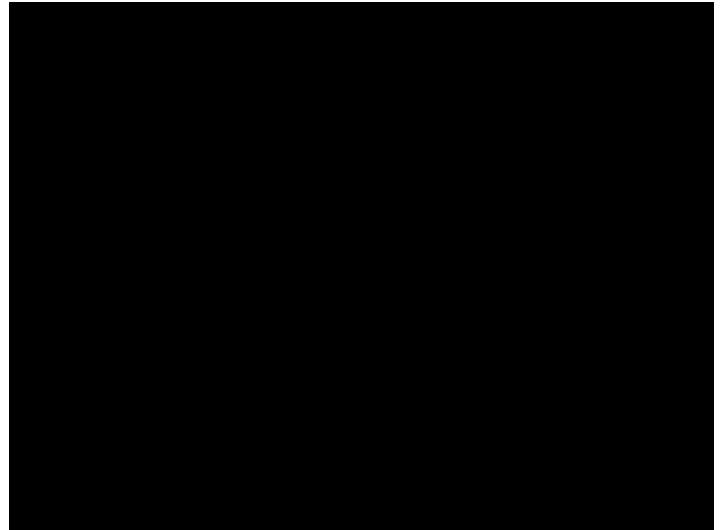

Villa Infinity Renders 01-25-32

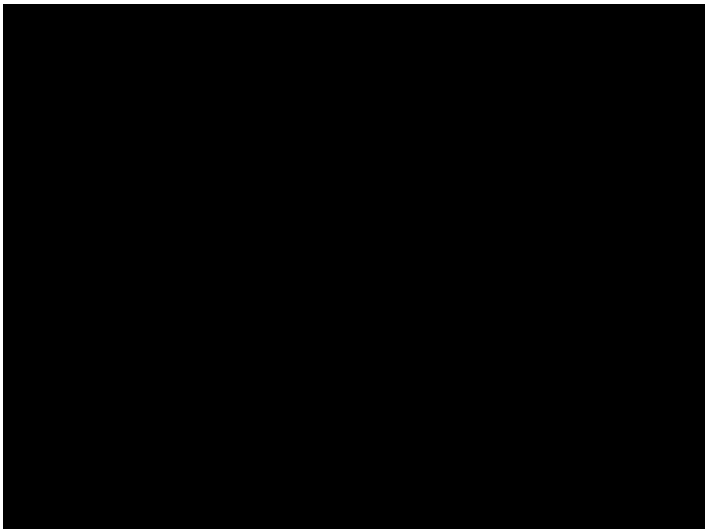

Villa Infinity Renders 01-25-29

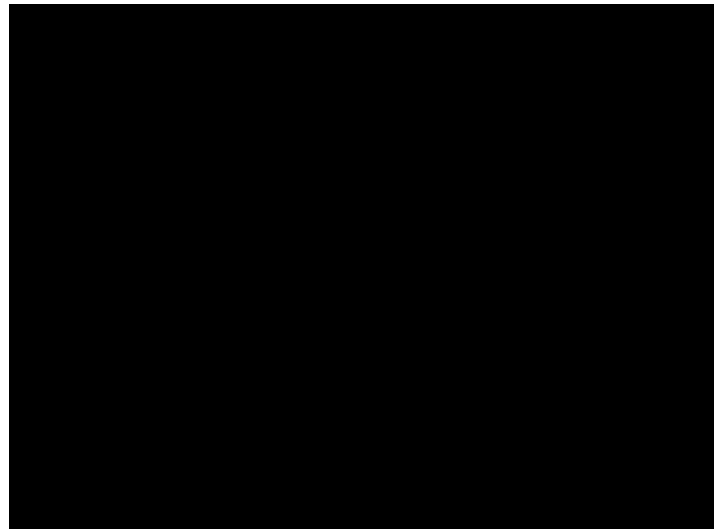

Villa Infinity Renders 01-25-4

All information is correct to the best of our knowledge. Errors and prior sale excepted. This prospectus is purely for information purposes. Only the notarized deed of sale is legally binding.

PORTA TENERIFE • C./ CONQUISTADOR 8, 07001 PALMA  
TEL. +34 971 698 242 • INFO@PORTATENERIFE.COM

Armeñime  
Reference 108037

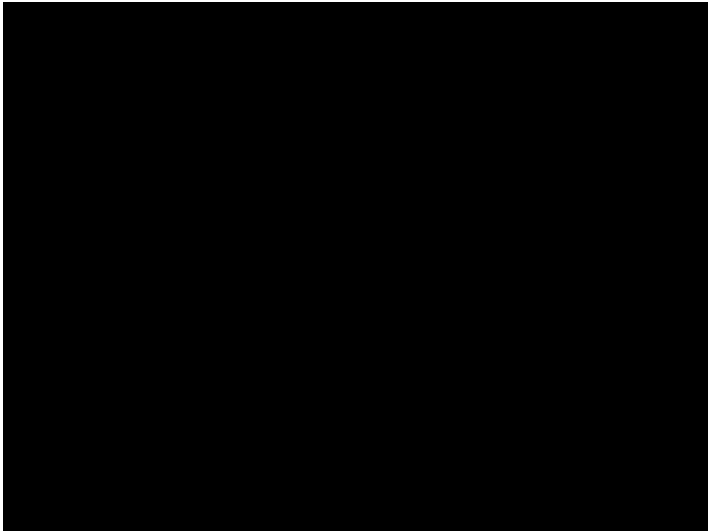

Villa Infinity Renders 01-25-7

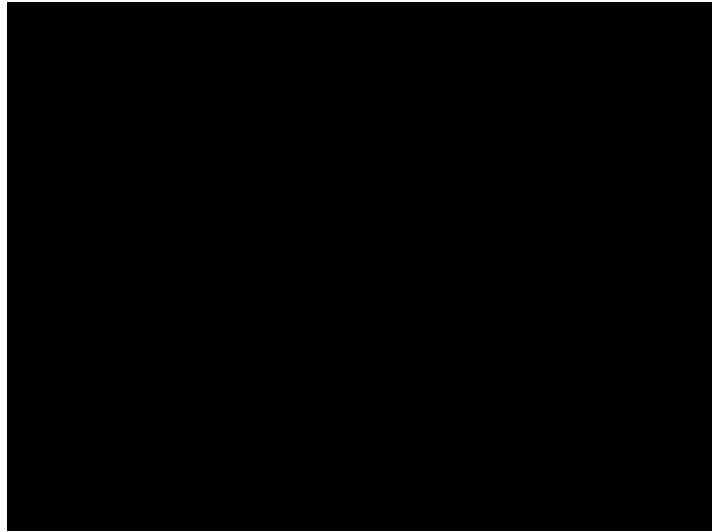

Villa Infinity Renders 01-25-26

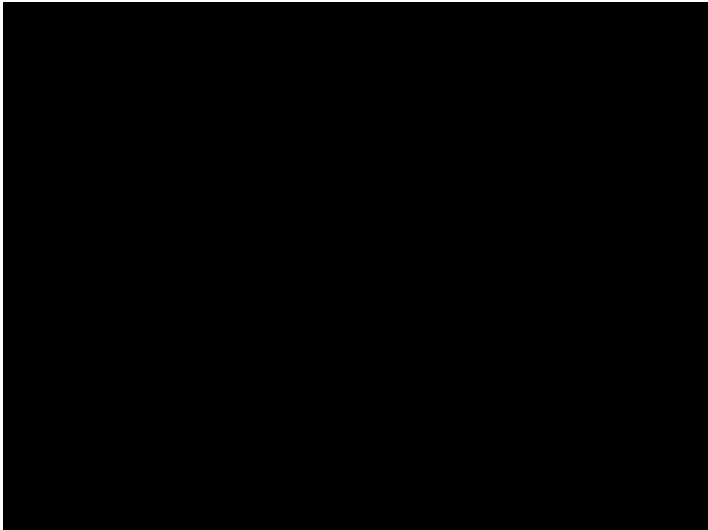

Villa Infinity Renders 01-25-28

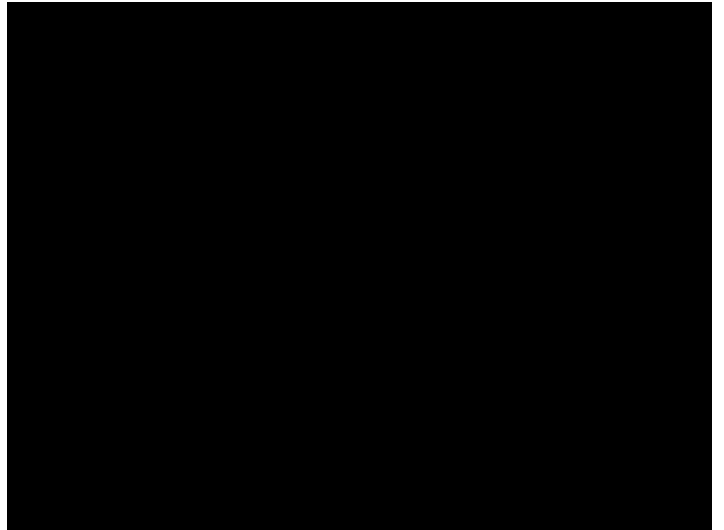

Villa Infinity Renders 01-25-27

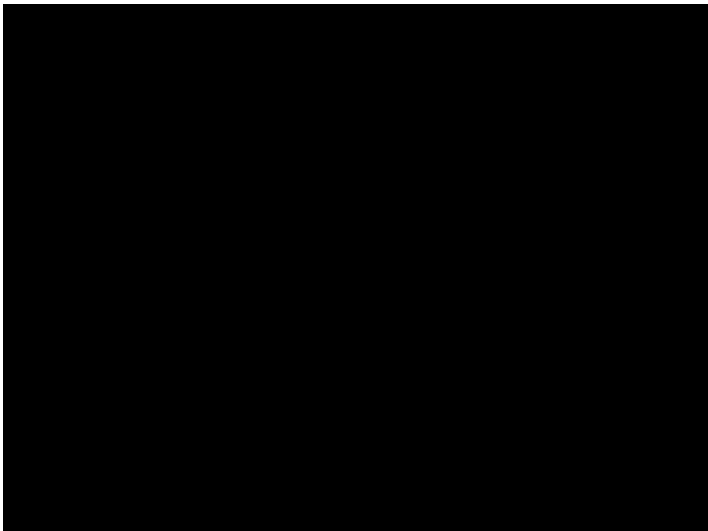

Villa Infinity Renders 01-25-9

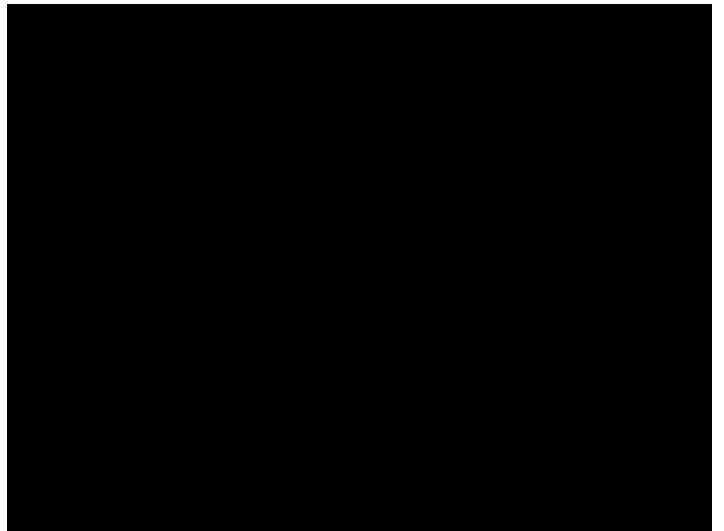

Villa Infinity Renders 01-25-8

All information is correct to the best of our knowledge. Errors and prior sale excepted. This prospectus is purely for information purposes. Only the notarized deed of sale is legally binding.

PORTA TENERIFE • C./ CONQUISTADOR 8, 07001 PALMA  
TEL. +34 971 698 242 • [INFO@PORTATENERIFE.COM](mailto:INFO@PORTATENERIFE.COM)

Armeñime  
Reference 108037



PORTA TENERIFE®  
Your home. Our passion.

Villa Infinity Renders 01-25-10

Villa Infinity Renders 01-25-16

Villa Infinity Renders 01-25-15

Villa Infinity Renders 01-25-13

Villa Infinity Renders 01-25-14

Villa Infinity Renders 01-25-6

All information is correct to the best of our knowledge. Errors and prior sale excepted. This prospectus is purely for information purposes. Only the notarized deed of sale is legally binding.

Armeñime  
Reference 108037



PORTA TENERIFE®  
Your home. Our passion.



Villa Infinity Renders 01-25-5

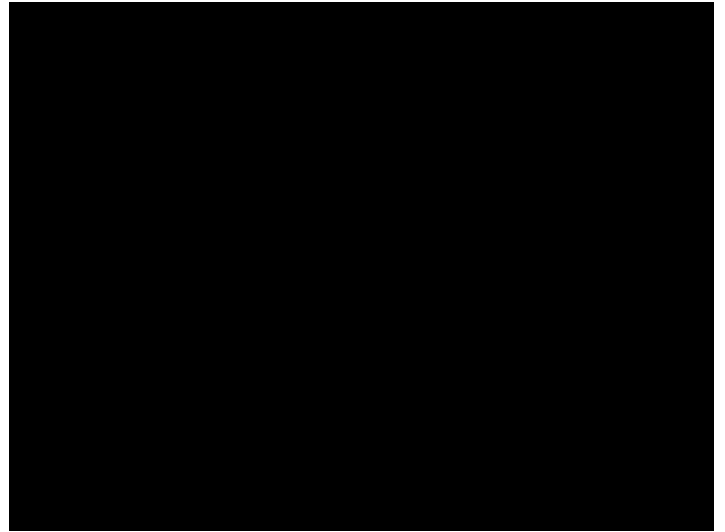

Villa Infinity Renders 01-25-3

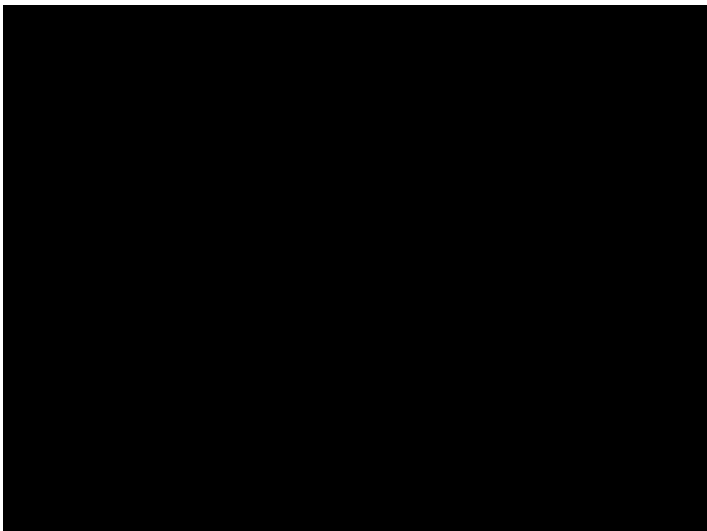

Villa Infinity Renders 01-25-2



0

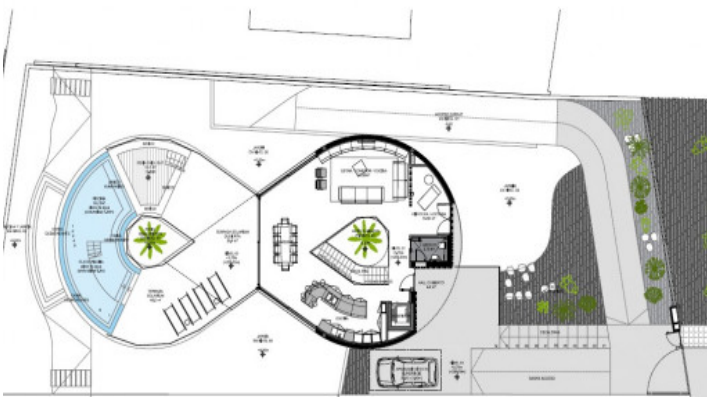

1

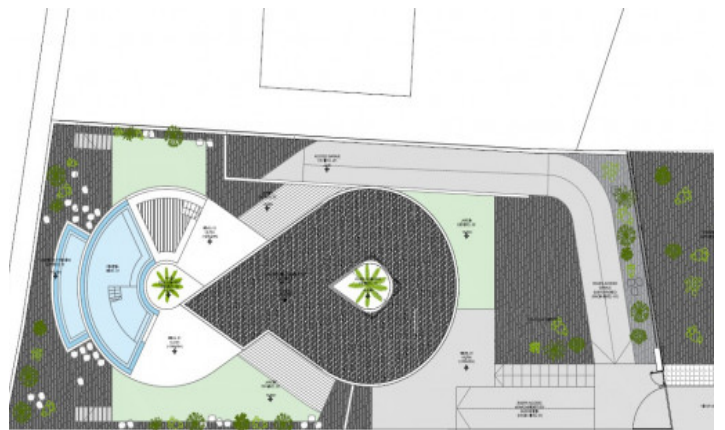

2

All information is correct to the best of our knowledge. Errors and prior sale excepted. This prospectus is purely for information purposes. Only the notarized deed of sale is legally binding.



# Armeñime

## Reference 108037



PORTA TENERIFE®

Your home. Our passion.

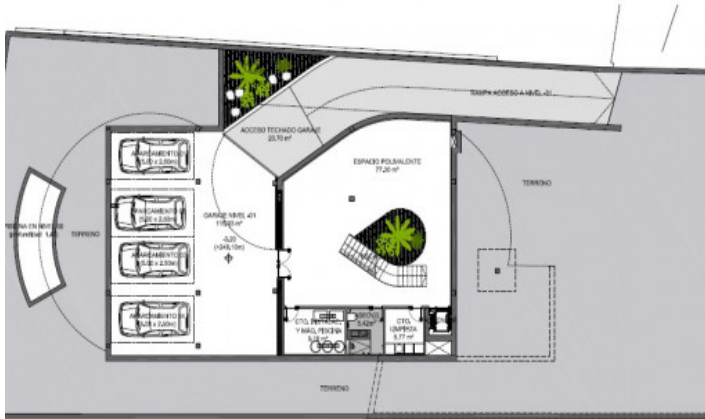

-1

All information is correct to the best of our knowledge. Errors and prior sale excepted. This prospectus is purely for information purposes. Only the notarized deed of sale is legally binding.

PORTA TENERIFE • C./ CONQUISTADOR 8, 07001 PALMA  
TEL. +34 971 698 242 • INFO@PORTATENERIFE.COM